



## Chiltern Avenue

Bushey

Offers over £1,000,000

A five bedroom detached house available on Chiltern Avenue with Davidson Frost-Wellings.

On the ground floor the house has a porch, welcoming hallway, multiple reception rooms, an eat-in kitchen, a guest WC and an integrated garage. On the first floor the house has a spacious master bedroom with en suite bathroom, plus four further bedrooms and a family bathroom.

The house is available chain free, with over 2200 sq ft of space, on a large detached plot with a rear South facing garden extending to over 131 ft. Fabulous aspect overlooking the park with the bowling green providing security to the rear. The property also offers extension potential, subject to planning permission with scope to modernise throughout, plus front driveway parking for multiple cars.

Hertsmere Council tax band F

### Viewing

Please contact our Davidson Frost-Wellings Office on 020 8954 8806 if you wish to arrange a viewing appointment for this property or require further information.

- Five bedrooms
- Two bathrooms
- South facing garden
- Extension potential (STPP)
- Chain free
- Freehold



# Floor Plan

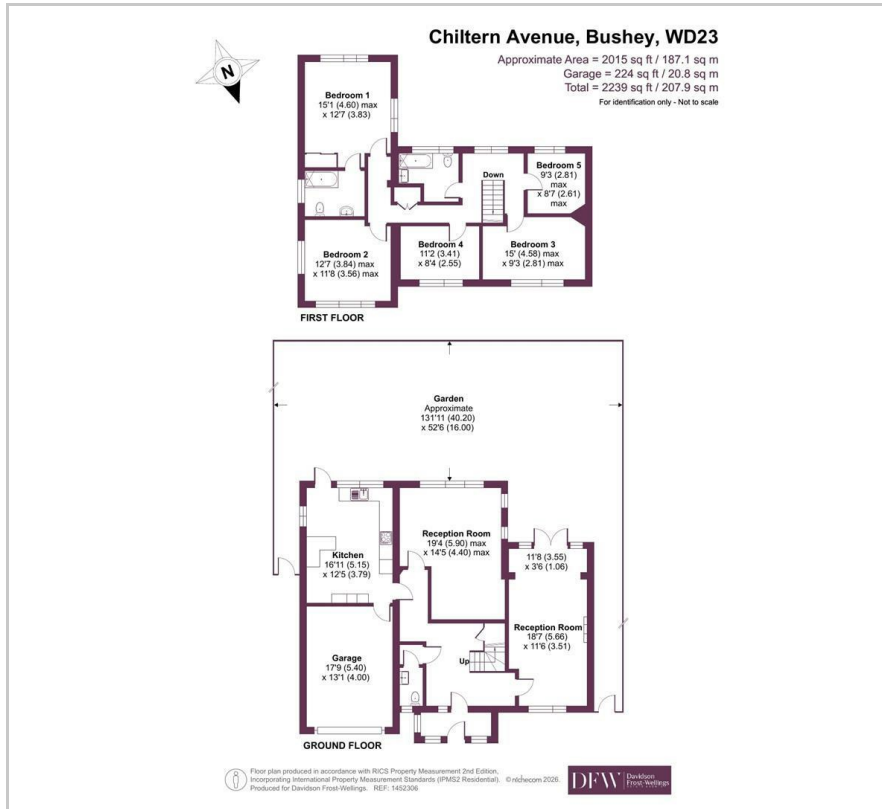

# Area Map

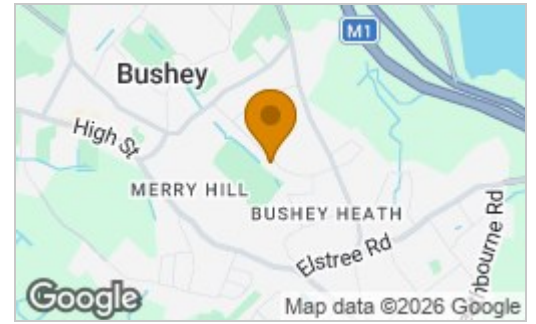

Energy Efficiency Rating		
	Current	Potential
Very energy efficient - lower running costs		
(92 plus) <b>A</b>		
(81-91) <b>B</b>		
(69-80) <b>C</b>		<b>77</b>
(55-68) <b>D</b>		
(39-54) <b>E</b>		
(21-38) <b>F</b>	<b>38</b>	
(1-20) <b>G</b>		
Not energy efficient - higher running costs		
<b>England &amp; Wales</b>	EU Directive 2002/91/EC	



These particulars, whilst believed to be accurate are set out as a general outline only for guidance and do not constitute any part of an offer or contract. Intending purchasers should not rely on them as statements of representation of fact, but must satisfy themselves by inspection or otherwise as to their accuracy. No person in this firm's employment has the authority to make or give any representation or warranty in respect of the property.